

# History Never Stops

A Campaign for the  
Winona County Historical Society



Winona County Historical Society, Inc.  
160 Johnson Street, Winona, MN 55987  
phone: 507-454-2723  
fax: 507-454-0006  
info@winonahistory.org  
www.winonahistory.org

# Table of Contents

Project Summary.....	1
Background of the Society.....	2-8
<i>Mission Statement</i>	
<i>History</i>	
<i>Programs/ Special Events</i>	
<i>Audience Served</i>	
<i>Funding</i>	
Board of Directors.....	9
Staff.....	10
Design.....	11
Floor Plans.....	12
About the Architect.....	13
Costs.....	14
Sustainability.....	15
Frequently Asked Questions.....	16-19
Fundraising.....	20
<i>Committee</i>	
<i>Gift Options</i>	
<i>Donor Recognition</i>	

## Project Summary

In the spring of 2004, the Society embarked on a needs assessment that ultimately led to a commitment to solve the Society's most pressing problem of not enough space. When the Society acquired the historic National Guard Armory in 1971 there were some that felt the building was too large and that the Society could never utilize all the space. Today the archives are overflowing, two large collections are stored offsite, the artifact storage collection is full and room for programs and special events is too often inadequate.

In the spring of 2006 the descendants of the Laird Norton Company, which started a sawmill operation in Winona in 1855, sold their business and offered the Society a \$1.5 million challenge grant for a building addition that would be given their name. The terms stated that the addition must be built onto the current Armory facility which had been donated by the Laird Norton company in the early 1970s. Following over a year of negotiations with the county, city and Winona Port Authority, the Society purchased the necessary adjacent property for \$85,600 from the Winona Port Authority. In July of 2007 the Society immediately began the process of selecting an architect and raising funds to meet the June 30, 2008 deadline for the Laird Norton challenge grant.

In November 2007, the Society selected architect/designer Joan Soranno from Hammel, Green and Abrahamson of Minneapolis. Following numerous discussions and design phases, the accepted conceptual design was unveiled on June 23, 2008 to an enthusiastic crowd at the museum. It was also announced that the Society had met the Laird Norton challenge in just 10 months! The Laird Norton Co. presented the Society with a symbolic check for \$1,500,000 and the final budget of \$4.5 million for the project was announced. The Steve and Barb Slaggie family graciously pledged \$250,000 when the Society raises another million dollars.

The Society is committed to not starting the construction until all the money and pledges have been raised. In order to complete the project in time for the Society's 75th anniversary in June 2010, work will need to begin in June 2009. There is also the added deadline of starting construction by August 2009 or the agreement with Winona County requires that and the adjacent land reverts back to the county.

The Society strongly believes that it will meet its fundraising goals and cut the ribbon in time to celebrate 75 years of service to all the people of Winona County.

*"The Laird Norton family and Company are excited about being a part of this wonderful and historic project that will benefit the WCHS and the whole county."*  
- Laurie Lucas, WCHS Board President

## Purpose

The Winona County Historical Society was established for the purpose of discovering, collecting, preserving, and interpreting objects that document the human activity in the geographic area legally defined as Winona County, Minnesota, and to disseminate the knowledge about this history to the general public.

The Society has established various means of fulfilling its stated purpose. Primarily by using objects that it has collected in exhibits and for research and study the Society illustrates the types and extent of human activity in Winona County. The Society has established several museum facilities and a library with archives which it uses as the primary means of dissemination of the knowledge of the history of Winona County.

## History

The Winona County Historical Society was founded in June 1935 at a meeting of interested citizens in the Winona County Courthouse. The first president was William Codman, a local attorney and amateur historian. The first secretary was Mildred Sebo, a local 4-H leader in the county. The year before, Mildred organized a Winona County historical pageant in Whitewater State Park that was very successful. It was from that event that the idea of starting the Society emerged.

The Society had its first headquarters in the Winona County Courthouse and later acquired space in the Arlington Club and at Phelps Hall at Winona State University. During and after WWII, the Society was relatively inactive. In 1954, a group of Winona citizens sought to revitalize the Society and approached Dr. Lewis I. Younger, a local physician and well known collector. Dr. Younger eagerly took on the responsibility of leadership and guided the Society over the next 21 years. The Society became one of the most active and well-respected county historical organizations in the state. During Younger's tenure the Society's offices and collection were moved into the second floor of the Lumberman's building where the UBC administration offices are now. The Society acquired the Bunnell House in 1956, the Arches Museum in 1964, the James Pearson (later renamed the Julius C. Wilkie) steamboat in 1956 (burned to the ground in 1981), First Baptist Church in Minnesota City in 1970 (given to the First Baptist Ladies' Aid in 1980), Robinson House in St. Charles in 1975 (sold in 1978), and the Gainey Schoolhouse in 1955 (given to the Fair Board in 1980). The Society's current home in the former National Guard Armory (built in 1915) was purchased and given to the Society by the Laird Norton Co. in 1971 and dedicated in 1973.

The Society hired its first full-time paid director in 1975 (Bill Gernes). When Gernes left in 1980, the Society hired Donn Young who stayed until 1982. The current Director, Mark Peterson, has been with the Society since February 1983.

# Programs

The Society reaches over 20,000 people each year through its programs, tours, events, research and many visitors to its three properties.

The Armory Museum offers a self-guided tour with various interpretive exhibits, including an award-winning children's exhibit. The second floor mezzanine features a unique Winona County time-line exhibit showcasing the Society's outstanding collection of Native American material as well as the history of Winona County from the prehistoric to the present. The main floor, in addition to the children's exhibit, features vintage Winona "Main Street" exhibits with a general store, barbershop, drug-store, blacksmith shop, and bank. The Society owns and exhibits a historic collection of Winona's 19th century fire equipment and horsedrawn vehicles. The main floor gallery also highlights changing and traveling exhibits.

The Bunnell House is open seasonally and offers guided interpretive tours of this 1850s Gothic style home built by Willard Bunnell, the first permanent white settler in Winona County. Various programs are offered at the site representing life here in the 1800s.

The Arches Museum is also open seasonally and offers guided interpretive tours focusing on Winona County's agricultural and pioneer history.



School tours of Armory Museum

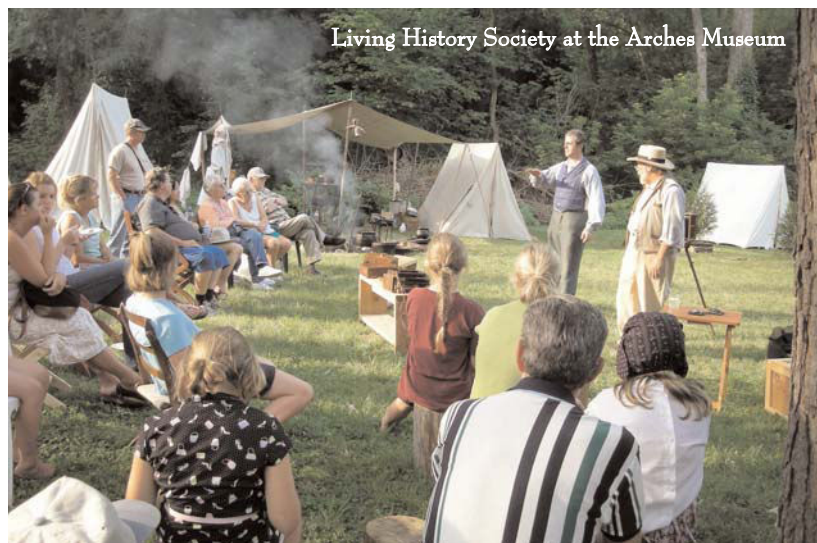

Living History Society at the Arches Museum

The site has a one-room schoolhouse, log barn, log house, and main museum. The museum showcases the collection of museum founder Walter Rahn's miniatures.

Each year the Society offers area school children the chance to step back in time and attend school in the one-room school at the Arches. The Pioneer School programs are taught at least three times each summer and last three half days each.

## Programs Continued

The Society provides guided tours for many visiting school groups each year at all three properties. The Society has actively encouraged the use of its meeting spaces by local groups with related interests. Currently, the Collector's Club, Civil War Roundtable, Quilt Guild, and Learning Club all regularly meet at the museum and other groups will often rent the space.

In addition the Society offers more opportunities for learning through the "Food for Thought" lecture series which runs year round. At least two noontime lectures on various historical topics are held every month. Past topics have included river music, heritage herbs, local legends, how to care for your textiles, medical history and much more.



The "History Book Chat" meets once a month reviewing pre-selected books of historical interest.

Young girls meet monthly as a part of the "American Girls Club."

A staff member or volunteer is available to go into area schools and offer programs on lumbering, early settlement, and Native Americans. Teachers can also check out learning trunks prepared by our staff on these topics to use in their classrooms.

The Society sponsors bus trips to regional museums, plays and special events. Featured highlight tours have included organized trips aboard the American Queen and a trip to Washington, D.C.

The Society wrote and narrated an automobile driving tour of the city of Winona for tourists to learn more about the history and architecture.

The Society regularly provides step-on guides for visiting bus groups and visitors aboard the many steamboats that stop in Winona each year.

The Society maintains one of the finest local historical library and archives in the state. The collection is very extensive and well organized. Particular strengths of the collection are its photograph collection of over 300,000 images and manuscripts, along with massive files on steamboats and upper Mississippi River history, genealogy, and historical subjects. Many members and non-members alike use these files and our archivists' expertise for research projects and programs.

## Programs Continued

The Society is active in publishing books related to Winona County history including histories of Beaver, St. Charles, Winona, Lumbering, and Native Americans to name a few. In addition, the Society publishes a bi-monthly newsletter, *The Argus*.

Society staff serve as a resource for the community to help answer questions concerning the National Historic Register program, building restoration, family history, and much more. Staff frequently work with all local media in answering questions that help relate current local issues with the past.



Pioneer School program at Arches Museum



Hands-on classes in our current multi-purpose room



*"The Winona County Historical Society is a huge and welcoming presence in this area. As a relatively young organization, we have been talking to them about some cooperative programs. The additional space gained in the new addition will help make some of these programs a reality. It's a great way both our organizations can serve the community."*

- Larry Gorrell  
former Executive Director  
Minnesota Marine Art  
Museum

## Special Events

A popular event every year is the Christmas House Tour. Annually the Society features six private homes for the public to tour. Consistently 500-600 people attend.

The Family Frolic was started several years ago to highlight the Arches Museum. In many ways this is a smaller version of the Victorian Fair and is particularly popular with the rural citizens of the county.

New in 1999 was the "Voices From the Past: Woodlawn Cemetery Discovery Walk." This event brings many of the people buried in the cemetery "alive" for one weekend in early October. Three weekdays are now set aside for all area sixth graders and the weekend is open for the general public. The growth has been remarkable, now attracting over 1,400 people per year.

The Annual Meeting has become more than a business meeting. It has developed into an event featuring interesting and entertaining programs that attract many of the Society's members.

New in 2004 was an event called "Chocolate, Champagne & Shakespeare." It is held at the Alexander Mansion B&B, a large Victorian home in Winona, and

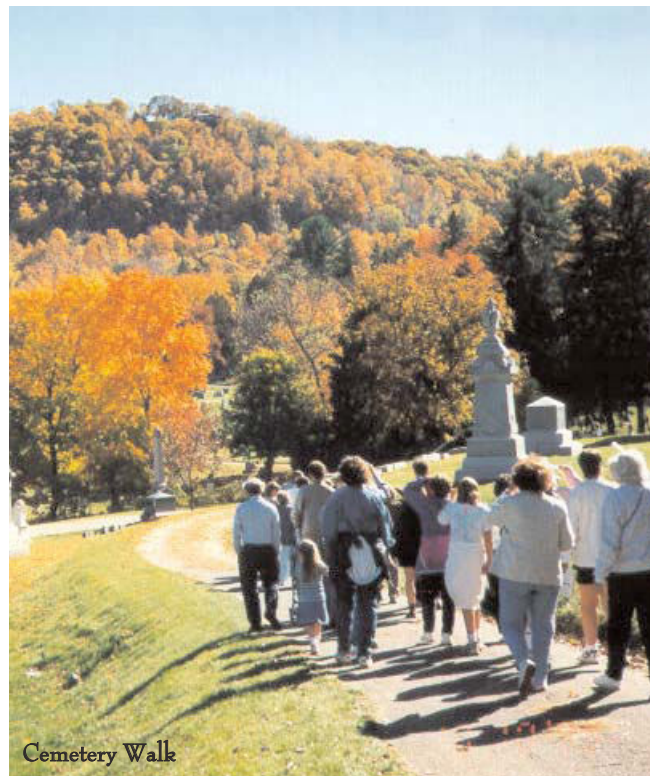

the Great River Shakespeare Festival actors provide entertainment which is enjoyed with a variety of chocolate desserts and chilled champagne. The event continues to grow in popularity.

For over 30 years the Society has sponsored a Victorian Fair (later renamed the Heritage Fair) which provided an educational, family-oriented event. The Fair included such attractions as the First Brigade Band, 1860s baseball, lumberjack shows, Old West shows, Parades, State Fair theme, high wheeled bicycles, wooden boats, and much more.

# Audience Served

The Society considers its audience to be anyone with an interest in learning more about the history of Winona County. Naturally the majority of visitors are citizens of Winona County, from school children to senior citizens. In addition, the Society serves a broad audience of visitors to Winona County from across America and beyond that tour one or more of the three properties it owns and operates.

## People Served 2007

Student Tours/Programs	
Armory Museum, Bunnell House, Arches Museum	2,067
Cemetery Walk	750
History Trunks	325
Special Events	
House Tour	600
Cemetery Walk	1,400
Heritage Fair	1,000
Chocolate, Shakespeare & Champagne	350
Open House	250
Programs (Food for Thought, Book Chat, special programs)	4,720
Business (information, meetings)	4,300
Archives (visitors & research)	1,787
Attendance	
Armory Museum	3,246
Arches	106
Bunnell House	275
Groups (Collector's Club, Civil War Roundtable, Quilt Guild, Spinners & Weavers, etc.)	2,344
Step-on Guides for Steamboat visits and bus groups	1,040
Total Served (not incl. E-mail and telephone inquiries)	24,560

## Finances

The Society operates on a calendar year basis with a budget that is prepared in advance by the Director and Finance Committee and approved by the board. The annual budget varies each year but averages around \$300,000. Approximately 40% of the budget each year goes to pay salaries while the rest is used to support the programs and properties. Government funding accounts for about 25% of the annual revenue. In 2008, Winona County contributed \$55,500 (we have had four increases since 1986 when the Society received \$46,000), the City of Winona \$17,000, and the Convention & Visitors Bureau \$12,000 (moved into the museum in 12/04.) The rest of the revenue is raised through membership dues, special events, admission fees, grants, endowment income, gift shop sales, tours, etc. Additional income is earned through Books Unlimited, the Society's used book store. Donated books and magazines are sold with all the profits going to the Society. The operation is housed in the main museum building and is all volunteer run and has been earning money for over 30 years now.

## Endowment Funds

The Society maintains two endowment funds. The Hiawatha Endowment Fund has an approximate value of \$520,000 and the Laird Lucas Endowment Fund has a value of about \$100,000. The interest from the Hiawatha Fund is used for general operating support while the interest from the Lucas Fund is used for the support of the library & archives. Both funds are invested locally and monitored by the Finance Committee of the board. The Society will accept restricted and unrestricted gifts for either of these two funds. A concerted effort began in 2001 to raise additional funds for the endowment. The Captain Orrin Smith Society has been established for recognizing endowment gifts of \$1,000 and over and to date has raised approximately \$40,000.

*"The Winona County Historical Society has brought the vision and creativity they've become known for in planning for their expansion needs in the 21st century. The result is a design that respects the past while it sets a high standard for what the future will hold for the organization and the larger community."*

*-Britta Bloomberg, Deputy State Historic Preservation Office*

# Board of Directors

The Society is governed by a Board of Directors composed of 18 citizens from throughout Winona County. One position is reserved for a Winona County Commissioner and one for a Winona City Council member. Board members are elected by Society members at the annual meeting. Terms are for three years and renewable for one additional three year term. The board meets monthly on the third Tuesday of the month at 4:00 p.m. Officers are elected by the board and consist of a president, vice-president, secretary (ex-officio) and treasurer.

## 2008 Board of Directors

Laurie Lucas, President  
James Kramer, Vice-President  
John Wolter, Treasurer  
Jonelle Moore, Secretary (ex-officio)  
Marianna Byman  
Ruth Erickson  
Peter Flick  
Carolyn Goplen  
Mike Kennedy  
Terri Lieder  
Bruce Montplaisir  
Julie O'Brien  
Judith Ramaley  
Tom Severson  
Ellen Smith  
Dave Stoltman, Winona County Commissioner  
Cindy Telstad  
Janis Vose  
Debbie White, Winona City Council

*"This project will benefit the whole county. It will help tourism and it will be educational for all schools in the county. It's a once in a lifetime chance. It's our turn to step up to the plate." - Jim Kramer, President Altura State Bank*

# Staff

Mark Peterson, Director (full-time)  
Jennifer Weaver, Assistant Director (full-time)  
Walt Bennick, Archivist (18 hrs./wk)  
Marianne Mastenbrook, Archivist (18 hrs./wk)  
Jodi Brom, Curator (15 hrs./wk)  
Joyce Betz, Asst., Housekeeping (12 hrs./wk)

The Society relies heavily on public programs for additional staffing. Summer tour guides are usually hired through the Summer Youth Program. Seasonal help at the Arches Museum is hired by the Society and funded by rental income from the attached apartment. Additional help also comes through the Experience Works (formerly Green Thumb) program and RSVP. The Society is fortunate to have over 200 active volunteers who serve the Society in many ways. While most prefer to help out with special events, many do volunteer on a regular basis at the front desk, in the archives, conducting school tours and much more.

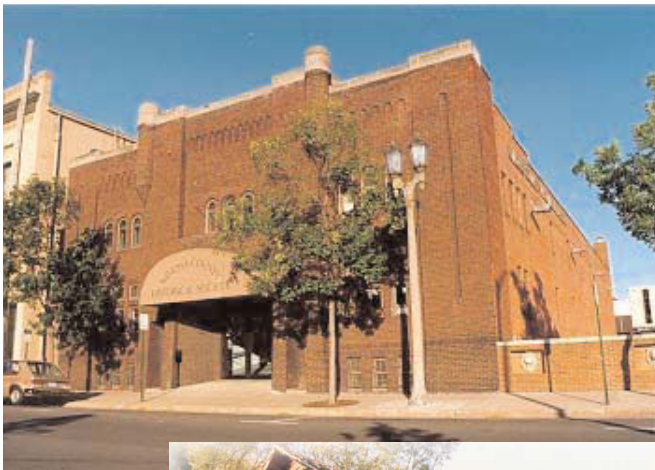

Armory Museum



Bunnell House



The Arches Museum of Pioneer Life

# Laird Norton Addition Design

The WCHS hired a contemporary architect that could balance the beautiful details of Winona's downtown historic architecture with a modern building that would compliment the heavy presence of the Armory building as well as respect the guidelines of adding onto a historic building on the National Register.

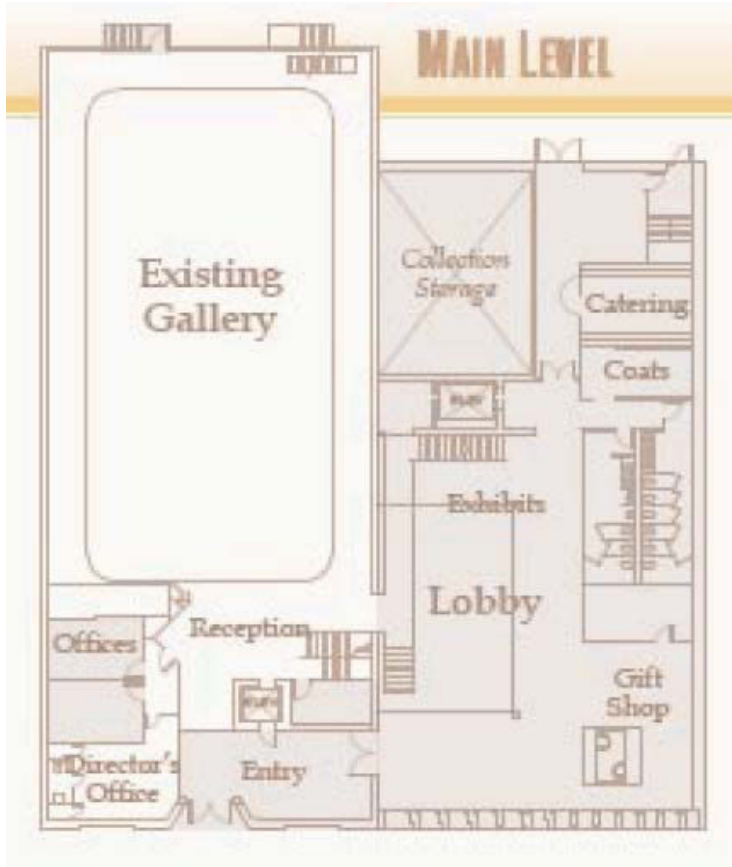

Illustration by Jerrald E. Ohm

*“Wow!...a thoughtful and innovative idea. The project is strong because it respects the original building. At street level it makes a successful dialog in terms of color, scale, and ‘weight’, and gives the old building enough room to breathe. The street should become energized with the new building. The innovation comes on the upper level- open, inviting, giving folks a view into history.”*

- Martha Thorne, Executive Director of the Pritzker Architecture Prize

# Floor Plans



*"The Historical Society is our past, present and future of Winona County and that is why we feel it is so important for all Winona citizens to support this project in any way they can. All contributions, whether large or small, help to make this dream a reality."*

- Barb & Steve Slaggie,  
WCHS members

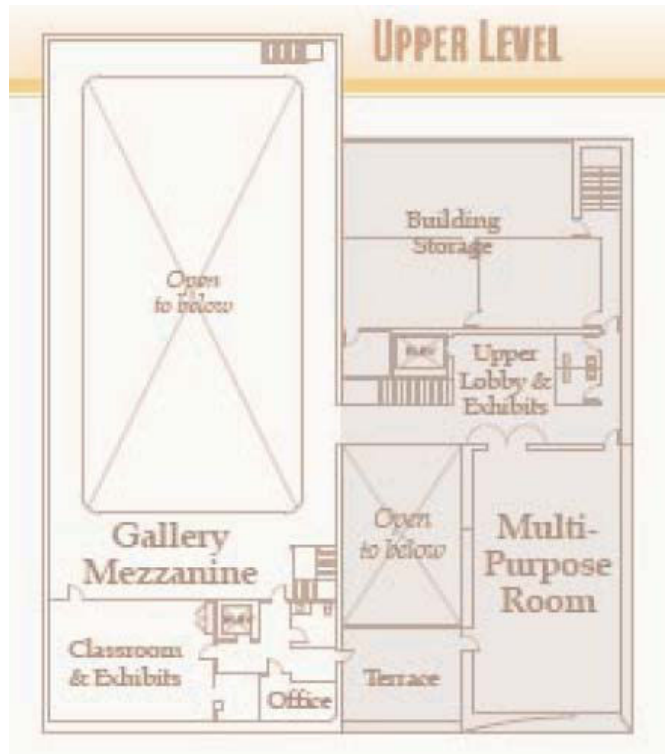
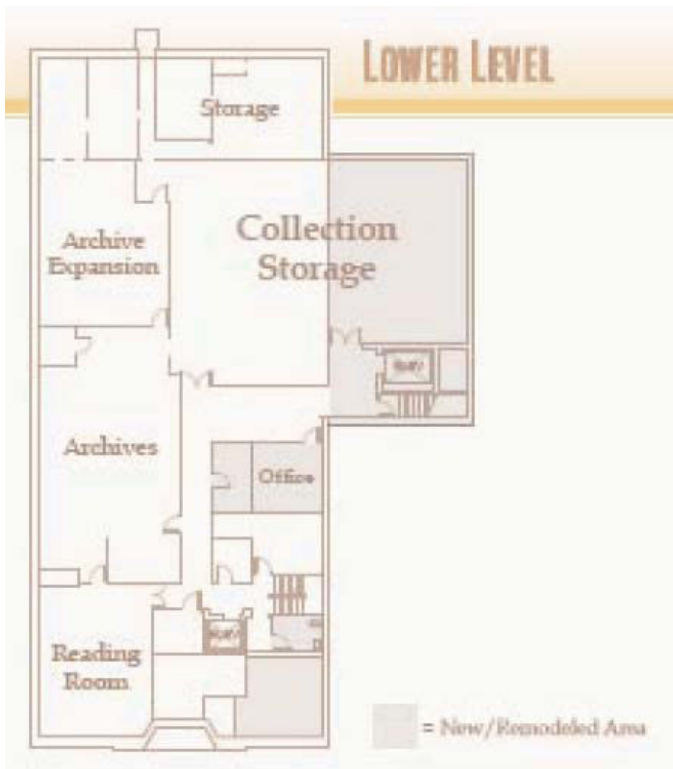

# About the Architect

Joan Soranno, AIA, is an award-winning architect specializing in cultural and educational facilities. Her passion for architecture is evident in her work style. With colleague John Cook as a project architect, she has created a small design studio within the large firm of Hammel, Green & Abrahamson. This studio approach serves as an incubator for innovative design in which her projects are aesthetically driven and technically challenging.

Throughout her career Joan's main focus has been museums. The recently completed University of Alaska Museum of the North in Fairbanks, Alaska is an architectural icon on the rugged northern landscape near the arctic circle.

An architecture graduate of the University of Notre Dame, this Boston native now residing in Minneapolis won the 1993 American Institute of Architects Young Architects Award for her design excellence and 2006 national AIA Honor Award for her design of the Bigelow Chapel in New Brighton, MN. Published in The New York Times, The Wallstreet Journal, and Architectural Record, Soranno continues to build upon her well-deserved recognition, placing design innovation in the forefront.



Joan Soranno

## RELEVANT EXPERIENCE

Historic Fort Snelling - New Visitor Center  
Saint Paul, Minnesota

University of Alaska Museum of the North  
Fairbanks, Alaska

Bigelow Chapel  
New Brighton, Minnesota

Dubuque Museum of Art  
Dubuque, Iowa

Minnesota Museum of American Art  
Saint Paul, Minnesota

Barbara Barker Center for Dance  
University of Minnesota

B'nai Israel Synagogue  
Rochester, Minnesota

Minnesota History Center  
Saint Paul, Minnesota

Minnesota Children's Museum\*  
Saint Paul, Minnesota

Frederick R. Weisman Art Museum\*\*  
University of Minnesota

Women of the West Museum  
Boulder, Colorado

The Minneapolis Institute of Arts  
Minneapolis, Minnesota

Minnesota Museum of American Art  
Saint Paul, Minnesota

\*with James Snow Architects

\*\*with Meyer, Scherer and Rockcastle

*"It's time for the Winona County Historical Society members to meet the challenge of erecting a new addition to the Armory Building. Such a strong membership can do it. The BEST county historical society in Minnesota will be made even better!"*

-Ann Brownell, St. Charles, MN  
WCHS member

# Total Project Costs

## *Funding*

Total Goal:	\$4,500,000
Amount Raised as of June 30, 2008:	\$3,000,000
Amount Needed:	\$1,500,000

## *Expenses*

*Building Addition (12,000 sq. ft.)* \$2,400,000

*Remodeling & Selective Demolition* \$500,000  
*(Includes current entry, gift shop, bookstore, reception area and office space)*

*Contingency* \$300,000  
*(10% inflation & Undeveloped design concepts)*

*Fees* \$500,000  
*(architectural, engineering, attorney, survey, soil borings & other misc.)*

*Furnishing & Technology* \$400,000

*Collection conservation & storage* \$140,000

*Exhibit Acquisition & Installation* \$100,000

*Archive Space & Offices* \$75,000

*Land Acquisition* \$85,000

*"The design is finished and it's wonderful. We have the adjacent land and the amazing gift from the Laird Norton Company has just been successfully matched. Now it's up to all the people of Winona County to determine if they will support it so we can build it for them and for the future."*

- Pete Woodworth  
Campaign Committee Member

# Sustainability

Because the Society wants a quality building that will serve its members and the community efficiently for many decades the Board has set a goal to seek LEED certification at the Silver level. The U.S. Green Building Council oversees the environmental certification program known as LEED (Leadership in Energy and Environmental Design) which has become the standard third party verification system to assess construction and renovation in terms of water conservation, energy efficiency and materials selection using a four level ranking system (Certified, Silver, Gold, Platinum).

This decision reflected our commitment to building the museum addition in an environmentally responsible way. Buildings consume about 30% of all energy and 60% of all electricity produced in the U.S. Every day about 5 billion gallons of potable water is used to flush toilets. We all have a stake in controlling our collective consumption of limited resources. Public awareness of the global impact of unrestrained use of energy and water has led to rapidly changing design standards in the building industry.

The Society is dedicated to helping protect our valuable resources and the Board recognizes that sustainable building is the only fiscally responsible way to manage a non-profit organization in an era of rapidly rising utility costs. Although sustainable building practices might cost more up front, these initial costs are usually recovered within a decade even at present utility rates. Energy analysts predict continually rising utility costs.

For these reasons, the "green building" movement has moved from the margins to the mainstream in the last few years. LEED Silver certification is quickly becoming a minimum standard driven by the fact that, for example, cities like Seattle and New York have made Silver a minimum requirement for new municipal construction. In Minnesota, a variety of public and private institutions have built or are planning LEED certified buildings. Great River Energy is seeking Platinum certification for its new headquarters in Maple Plain. They project that their new building will consume 10% of the water of a traditional building of the same size. In Minneapolis, structures as diverse as the university's new football stadium and the Red Stag Supper Club will be LEED certified.

The Society is optimistic the museum addition in Winona will be the first LEED certified museum in the state of Minnesota.

*"The WCHS has done an excellent job preserving the history of all the people of Winona County since 1935. We are now making history with this exciting new addition."*

- Mark F. Peterson, Executive Director

# Frequently Asked Questions

## **Why does the Society need more space?**

Since its founding in 1935, the Society has collected artifacts and archival materials that document the history of Winona County. The Society is trusted to care for and preserve these items so that future generations can learn from them. The Society has run out of room in its current museum facility and is renting storage space offsite for some of its larger archival collections. The Society also offers an active schedule of programs for all ages that are increasingly well attended. This often requires rearranging the exhibits on the main floor.

The current library & archive space is 2166 sq. ft. The expanded archives will gain 1,342 additional square ft., a 62% gain. There will also be 1,000-sq. ft. of new storage space in the addition that will be 16' high. The expanded archive space will share collection storage space until such time the archives needs all that space. Long-range plans call for the installation of space-saver shelving in both the archives and collection storage areas that would add an addition 30% capacity. The new multi-purpose room located on the second floor of the addition will be 1,590-sq. ft. with a capacity of approximately 150 people. The new addition will include space for more exhibits in the new lobby (2,283-sq. ft.) and in the upper lobby off the multi-purpose room (818-sq. ft.). Other opportunities for exhibiting items from the collection will include wall space throughout the new addition and in exhibit cases built in wherever practical. There will also be space freed up in the current museum that will be utilized for additional semi-permanent and traveling exhibits.

## **Who is chairing the capital campaign?**

The campaign is being chaired by Jim Kramer, President of the Altura State Bank and WCHS Vice-President.

## **What will the building look like?**

Following a thorough search the Society selected architect Joan Soranno of Hammel, Green and Abrahamson in Minneapolis. The Society is committed to building the most attractive, best-designed building we can on the site. We feel Ms. Soranno has designed a contemporary building that respects the historic armory building. We believe it is an original, stunning, 21st century design that will add to the other significant architecture in the downtown area.

## **Can I make pledges? If so, how many years?**

You may make a pledge which will be accepted for up to three years. Pledges will count toward the Slaggie Family challenge grant match.

## **Do you have a professional fundraiser working with you?**

The Society has not hired a professional fundraising service for its campaign. However, the Society has been graciously assisted by several professional fundraisers. All work is being done by staff and volunteers.

## Frequently Asked Questions Continued

### **Is \$4.5 million enough to do all you are planning to do?**

The total project budget of \$4.5 million allows for a 12,000 sq. ft. addition, the remodeling needed to support the addition, furnishings for the new building, upgrading of technology, and integrating the exhibits, collections and archives into the new and remodeled space.

### **Why did the County board require over 12 months to sell the parking lot to the Society?**

In every instance a majority of the county board supported this project. Several legal hurdles had to be cleared and dealt with regarding the sale of public property to a non-profit organization. The Society worked together with the County Board, Port Authority and City of Winona to reach an agreement favorable to all parties and was pleased with the outcome.

### **What are the terms of the agreement with the Laird Norton Co.?**

The terms of the agreement with the Laird Norton Co. are that the building addition will carry the name of the company, the Society had to match the \$1.5 million by June 30, 2008, and that their family representative, Laurie Lucas, will remain on the Society's board until the project is completed.

### **Has the Society hired a construction manager?**

The Society selected Alvin E. Benike, Inc. to provide construction management services for the building. All subcontractors will be selected through competitive bidding.

### **Will the Society be asking foundations for their support?**

The Society has established longstanding relationships with a number of foundations that have lent their support. We will continue to explore local, regional, state and federal funding sources.

### **How much money does the Society receive from Winona County each year?**

In FY 2007 the Society received \$55,500 from Winona County. In 1986, the Society received \$46,000. In comparable dollars that would be over \$80,000 in today's money.

### **Will there be parking?**

There will be 5-6 parking spaces for volunteers and staff in the rear of the building. The Port Authority is developing new parking across Fourth St. that will be available for patrons day and night.

## Frequently Asked Questions Continued

### **How can someone find out more about the Society?**

Our website [www.winonahistory.org](http://www.winonahistory.org) has a lot of information about the Society and a calendar that is updated with information about our programs and events.

### **How much are dues to the Society?**

Individual \$25, Family \$40, Senior Individual \$20, Senior Household \$30, Contributing \$100, Sponsor \$250, Sustaining \$500, and the Capt. Orrin Smith Society \$1,000.

The Society has over 1,200 members, which makes it the largest county historical society in Minnesota.

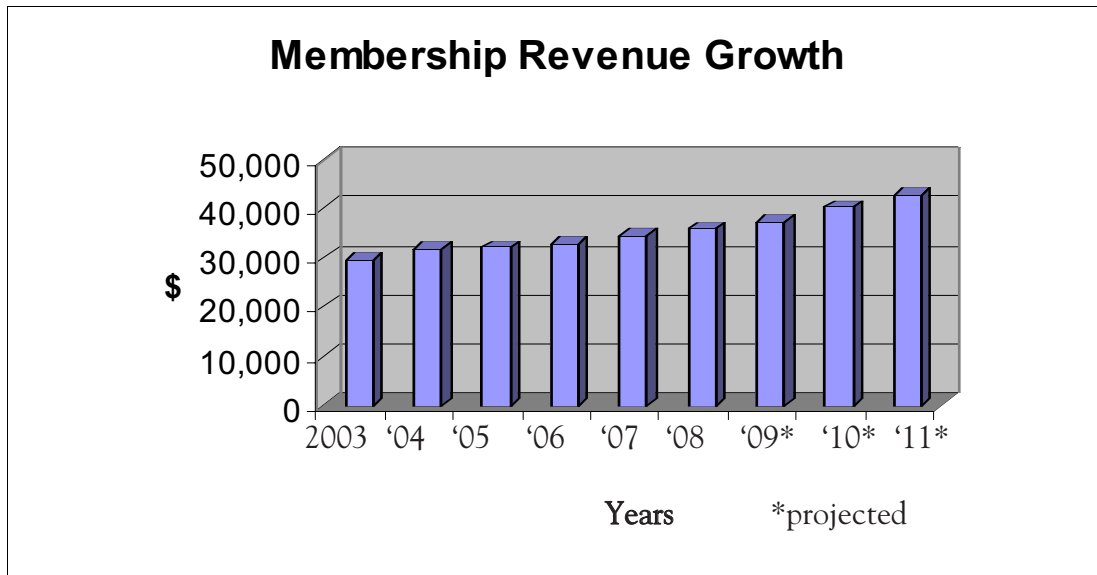

### **How many people does the Society serve each year?**

The Society serves a large number of people each year through visits to our museum sites, research, program and special event attendance, gift shop, used book store shoppers, e-mail, website visitors, and in-school and other site programs. The Society has seen a steady growth in the attendance at its events and programs and anticipates that when the addition is completed this trend will continue to increase.

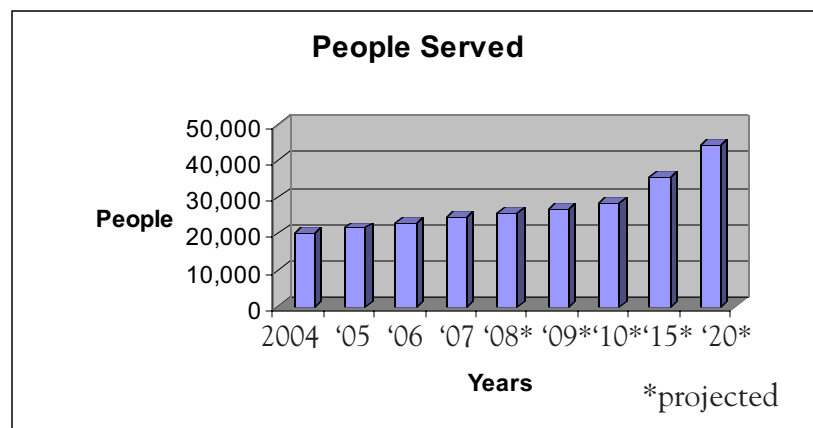

## Frequently Asked Questions Continued

**How will the Society be able to afford the additional expense of another 12,000 sq. ft. of operating space?**

The Society expects that the added utility, insurance and cleaning expenses will be largely off set by the increase in admissions, gift shop/book store sales, membership dues and rental of the new meeting space. With every effort being made to make the building as “green” as possible the added utility costs will be kept to a minimum. Anticipated increased revenues from room rentals and other non-government funding sources, which make up 75% of the Society’s annual budget, are expected to increase, covering these minimal increases.

Expected total annual expense increase after 2011: \$17,000

Expected total annual revenue increase: \$16,000

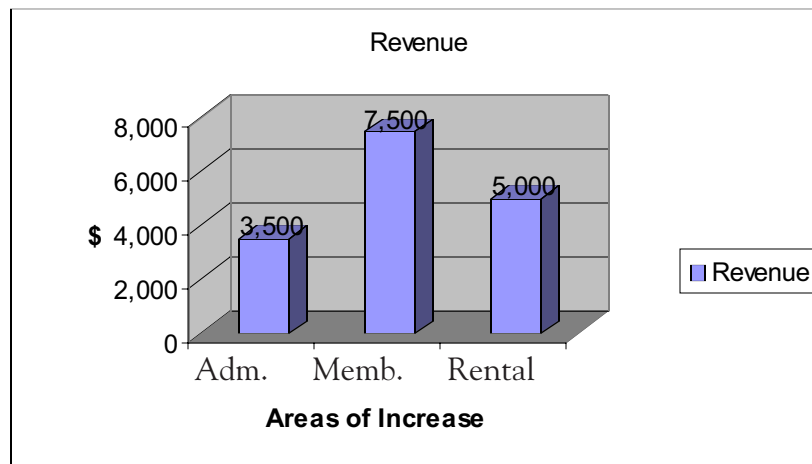
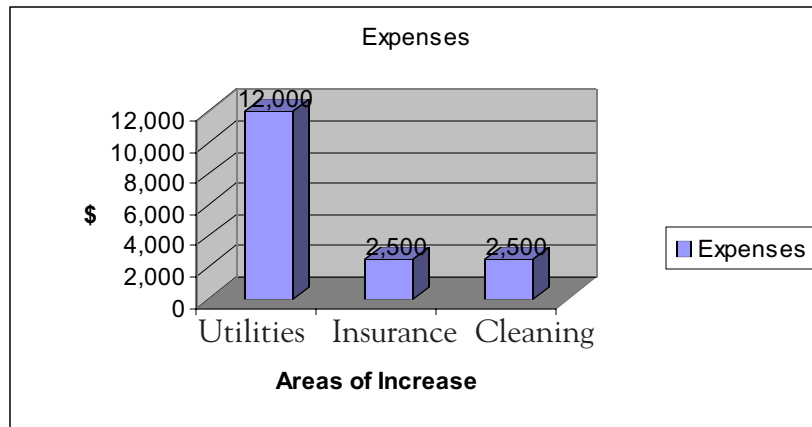

## Fundraising Committee

Jim Kramer, Chair

Harry Buck

Katie Buck

Jim Erickson

Ruth Erickson

Phil Feiten

Peter Flick

Greg Gaut

Bruce Harem

Laurie Lucas

Marianne Mastenbrook

Mark Metzler

Mary Pendleton

Mark Peterson

Kathie Peterson

Cindy Telstad

Peter Walsh

Jennifer Weaver

Debbie White

Pete Woodworth

## Building Committee

Peter Flick

Greg Gaut

Mike Kennedy

Jim Kramer

Laurie Lucas

Mark Peterson

## Funding Options

In addition to cash gifts the Society will accept pledges up to three years. Gifts of stock, mutual funds and appreciated property are also good ways to help the society achieve its goal. Donors should consult with a financial advisor to find what works best for them.

## Donor Recognition

All donors will be permanently recognized in *The Argus*, the official newsletter of the Society. In addition, donors will be visibly recognized in the lobby or vestibule of the addition.

There will be numerous room-naming opportunities in areas of the new addition. If this interests you please contact Mark Peterson at the Society.